

## *DUFOUR 350 Grand Large*

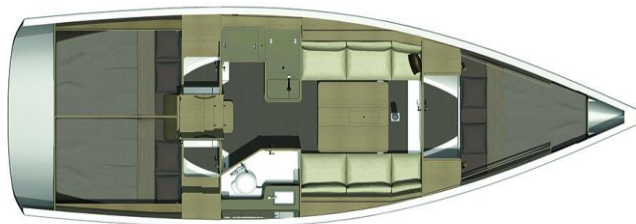

YEAR 2015

<b>Length overall 10,28 m</b>	<b>Draft 1,90 m</b>
<b>Beam 3,54 m</b>	<b>Engine Volvo 29 HP</b>
<b>Displacement 5674 kg</b>	<b>Genoa <b>REFIT 2019</b> 25.5 m2</b>
<b>Water capacity 220 l</b>	<b>Sail area 55 m2</b>
<b>Fuel capacity 160 l</b>	
<p style="text-align: center;"><b>EQUIPMENT</b></p> <ul style="list-style-type: none"> <li>• Tender</li> <li>• Teak cockpit</li> <li>• Hot water</li> <li>• Cockpit table</li> <li>• Furling main sail</li> <li>• Roll genoa</li> <li>• Electric windlass</li> <li>• Bimini top &amp; sprayhood</li> <li>• Solar panels <b>NEW 2022</b></li> </ul>	<p style="text-align: center;"><b>ELECTRICAL EQUIPMENT</b></p> <ul style="list-style-type: none"> <li>• GPS with plotter in cockpit</li> <li>• Autopilot</li> <li>• Speed and echo log</li> <li>• VHF</li> <li>• Radio-CD player with cockpit speakers</li> <li>• Wind instrument</li> </ul>
<p style="text-align: center;"><b>OUTSIDE</b></p> <ul style="list-style-type: none"> <li>• 2 winch handles</li> <li>• 2 anchors with chain</li> <li>• ropes</li> <li>• 6 fenders</li> <li>• boat hook</li> <li>• wind direction indicator</li> <li>• life bouy</li> <li>• 2 gas bottles</li> <li>• byboat pump</li> <li>• water hose + brush</li> <li>• bilge pump + handle</li> </ul>	<p style="text-align: center;"><b>INSIDE</b></p> <ul style="list-style-type: none"> <li>• charts</li> <li>• plotters + divider</li> <li>• hand bearing compass</li> <li>• binoculars</li> <li>• pilot books</li> <li>• life jackets</li> <li>• first aid kit</li> <li>• portable lamp</li> <li>• tools</li> <li>• clock + barometer</li> <li>• kitchen equipment</li> </ul>

Anchor & remote control

Water tank cap



Ropes, bucket, brush, spare anchor, rudder

Gas bottle

Water tank cap

Diesel tank cap

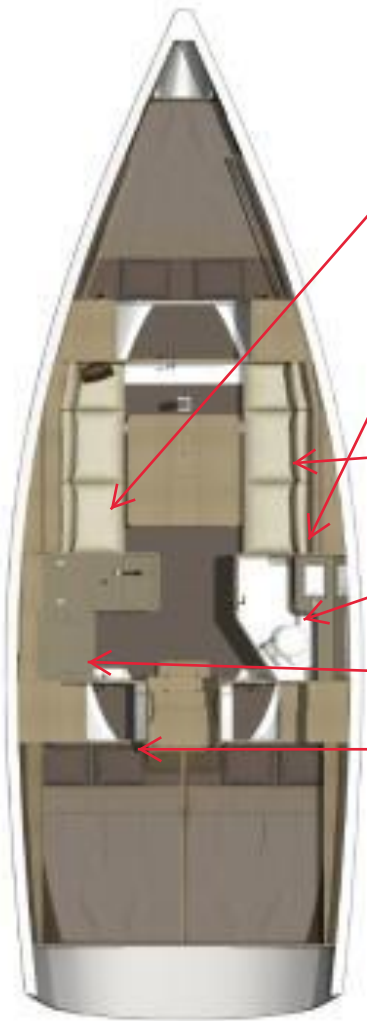

Water tanks switch

Main panel & anchor winch switch

Life jackets

Waste tank plugged-in

Gas valve

Main 12V switches

Roll main sail

Roll genova

Mast height < 16m

One rudder blade

Draft 1,90m

